



9<sup>th</sup> September 2016

**RE: NEW BUTLER GALLERY AT EVAN'S HOME, BARRACK LANE, KILKENNY.  
REVISED SCHEME - RECOMMENDATION TO PROCEED TO FORMAL PART 8**

A Chairde,

This proposed development for the Butler Gallery at Evan's Home follows on from an existing Part 8 permission obtained in June 2011 (from Kilkenny Borough Council). Due to funding constraints at that time the project did not proceed.

The proposal has recently been revisited consisting of the refurbishment of the existing Evans Home for use as the Butler Gallery with the addition of a small extension at the northern end for lift, stairs, wc accommodation and media gallery. The scheme also involves the upgrading of the grounds to form an 'art & sculpture garden' around the building. The works include a new set of steps, railings and a ramp from the Carnegie library car park to the refurbished building to open it up to the city, linking across the river via the Lady Desart pedestrian bridge to the planned river garden on the western bank.

In accordance with the Council's Part 8 procedure adopted in March 2016, a Pre-Planning Application for the Part VIII Development was submitted to Planning Department on 22.06.16.

The response from the planners is such that the scheme has been assessed and screened for Appropriate Assessment and none was required.

I now recommend that we proceed with the formal Part 8 process with public consultation to commence on Friday September 23<sup>rd</sup> 2016.

Mise le Meas,

  
Mary Mulholland,  
Director of Services



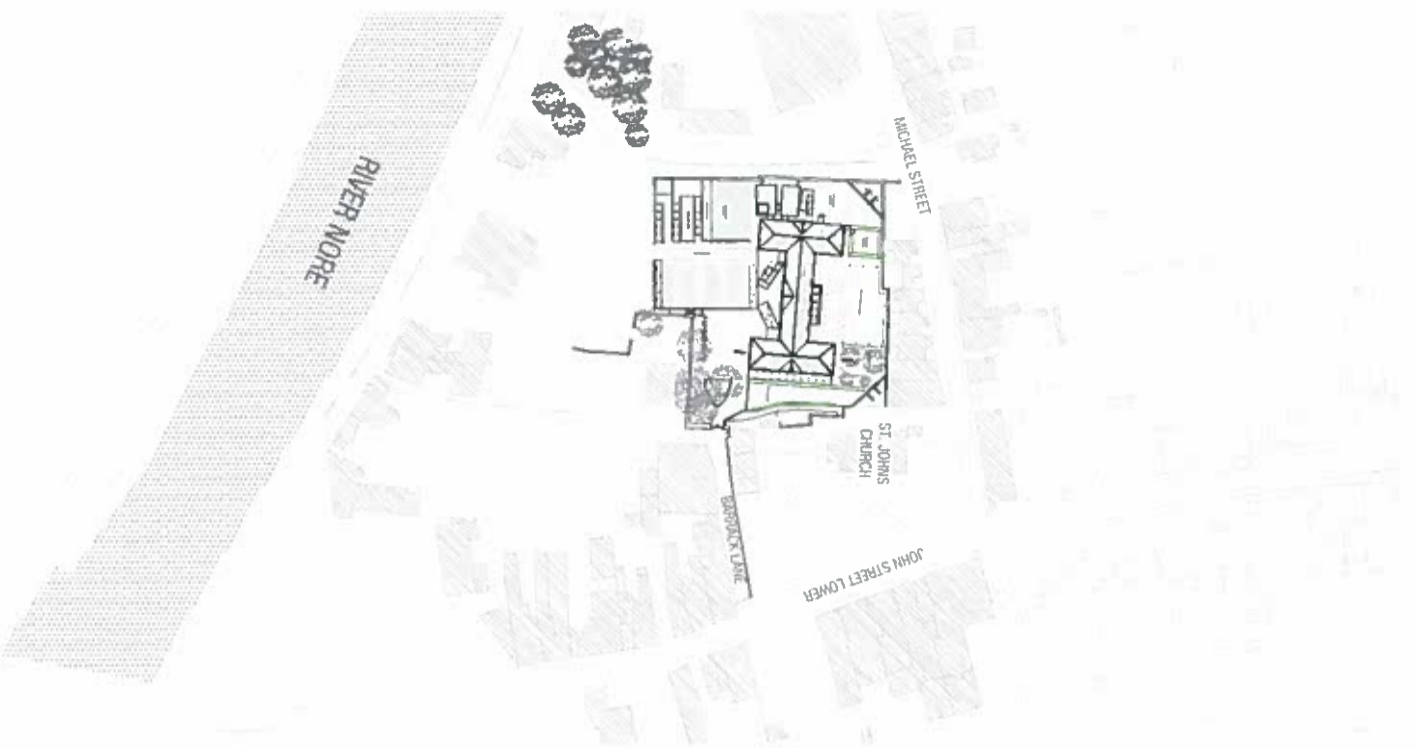

SITE PLAN 1:1000

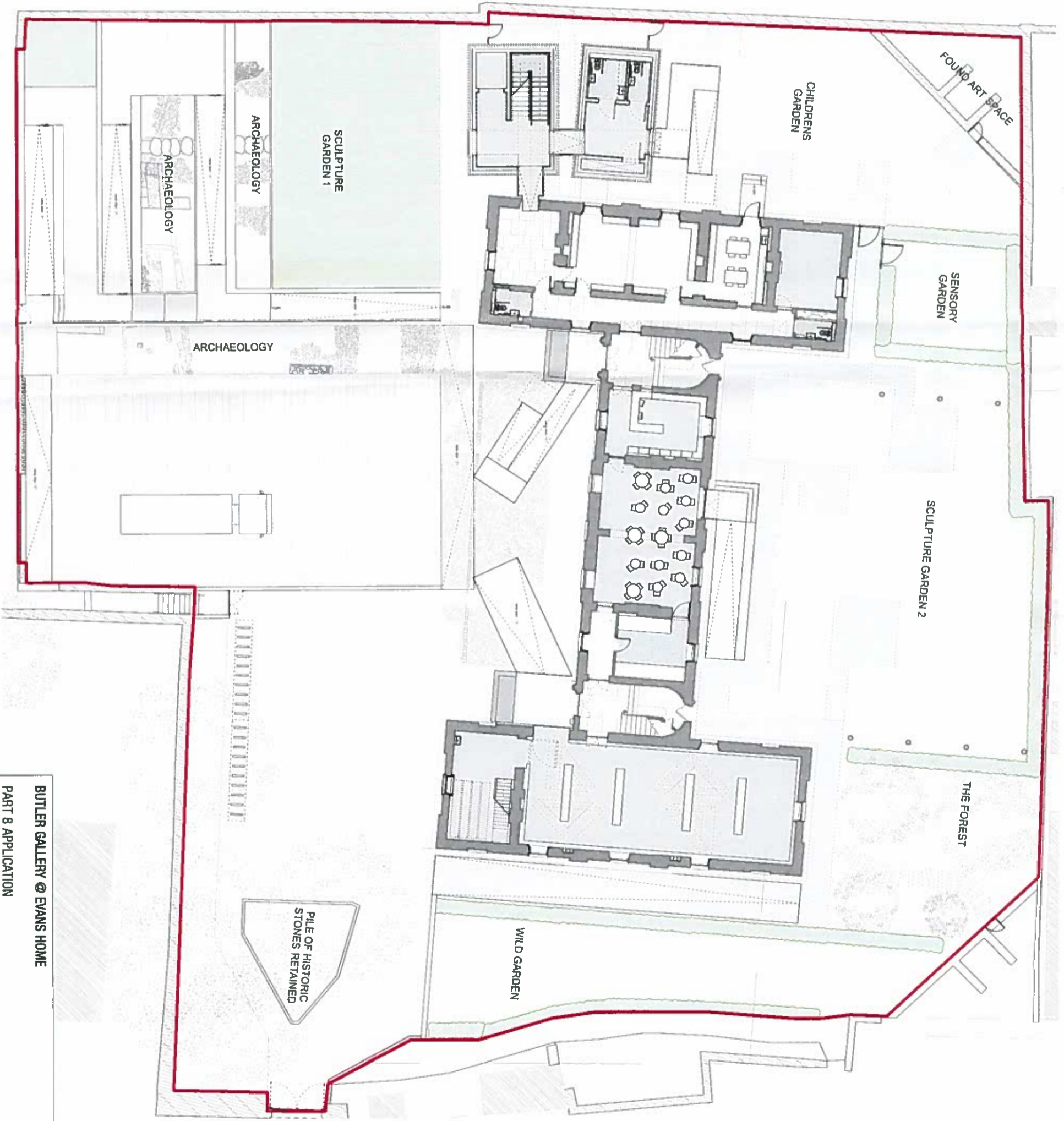

SITE PLAN 1:125

**BUTLER GALLERY & EVANS HOME**  
 PART 8 APPLICATION  
 SEPTEMBER 2016  
 McCullough Mulvin Architects



1. New ramp and main entrance  
Parking earned to bridge and river
2. New ramp to upper level
3. Formal sculpture garden 1
4. Children garden + Pavilion
5. Formal sculpture garden 2
6. Forest garden
7. Wild garden
8. Mound of Fragments
9. Parking to John Street
10. Potential access to  
ramp of St John

**Site Plan**



